

PD FOUNDATION TENSIONER

THE MOST ADVANCED INDUSTRIAL TIGHTENING TOOL



Foundation tensioning is one of the most complex tightening operations in a wind turbine assembly project. Aspects such as dirt, misalignments, rust, elongation control, oil return speed...makes difficult the bolt tightening, and can cause assembly errors. This family of tensioners are designed to facilitate foundation tightening.

Safety is another aspect that should be not neglected. We have included safety features commonly used by Texas Controls in other series of tensioners.

A special design of the bridge for offshore applications is available under request. An increased contact area helps to reduce the contact force against the flange, avoiding damages in the corrosion protection paint.

Our designs and developments have proven to be the most reliable, user friendly and fastest units on the market, based on constant improvements achieved during our co-creation processes.

»» BOLTPILOT® INSIDE

The BoltPilot System is a Multi-Farm Platform that defines the complete Wind Farm, each Turbine and each Turbine's bolted joints. From that valuable information, the System Controls, Guides, Assures and Records all bolt tightening processes without interfering with the existing procedures.

Among all other features, the System will assure and record:

- **Torque or Torque and Angle Applied.**
- **Tension or Tension and Residual Elongation.**
- **Skidmore Calibration Procedures.**
- **Manufacturer's Specific Procedures.**

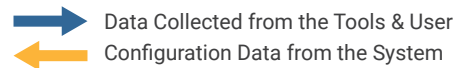

PD FOUNDATION TENSIONER

THE MOST ADVANCED INDUSTRIAL TIGHTENING TOOL

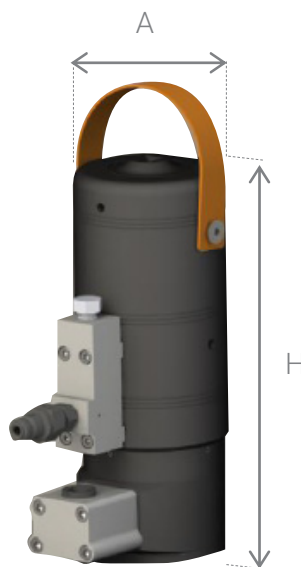
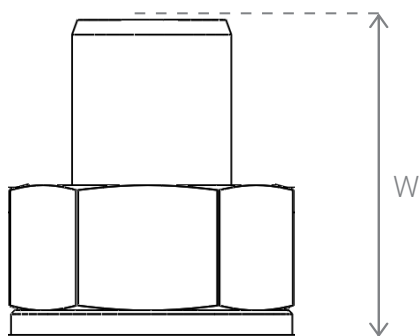

Model	Stud Size	Max. Pressure	Tool Load Capacity	Hydraulic Pressure Area	Effective O.D. (A)	Tool Height (H)	Max. Stroke	Stud protrusion over flange (mm) (W)		Complete Tool Weight
	Metric	bar	kN	mm ²	mm	mm	mm	Min	Max	kg
GRB36	M36	1350	657,8	4.872,61	98	257,67	15	143	242,34	10,3
	M36- OFFS	1350	657,8	4.872,61	98	257,67	15	143	242,34	10,5
GRB42	M42	1350	877,9	6.502,96	105	259,35	15	178	243	11,5
PD36	M36	1500	579,9	3.866,28	98	257,67	15	143	242,34	10,3
PD39	M39	1500	702,9	4.685,70	102	255,75	15	136	230	10,0
PD42	M42	1500	787,6	5.250,56	105	259,35	15	178	243	11,3
PD48	M48	1500	1.060,7	7.071,16	125	258,15	15	145	239,83	17,0
PD56	M56	1500	1.461,6	9.744,14	141	264	15	155	243,72	25,0

» MAIN FEATURES

SAFETY

PD tensioners incorporates the same safety features than the blade tensioners:

- Anti-projection device in case of a puller bar failure.
- Positive Stop.

SLIM DESIGN

Double decker type ensures high loads in limited radial clearance applications.

LASER ENGRAVED SCALE

Allows an easy elongation control by the user.

GEAR BOX

We have the most reliable gear box in the market. Fastest Oil return, avoiding unnecessary time wasting.

OPTIMIZED DESIGN

Double hydraulic chamber that ensures a high load in a smaller diameter, which favors its use in applications with limited radial space. Versatile model, adaptations can be made. Closed tensioner that allows a higher bolt height without the need to increase the time spent in threading the bolt. Available for short bolt versions.

Improved square drive design. / Different Thread Tolerances available. / Different nut sizes and types available.